



PMV[®] Rotary Valve

*Durable
Reliable
Adaptable*

*Rebuildable
on site*

*Over 2,000
in service
throughout
the world*

*Available as:
UltraValve
Severe-Duty
Standard-Duty*

*Celebrating
30 years!
1977-2007*

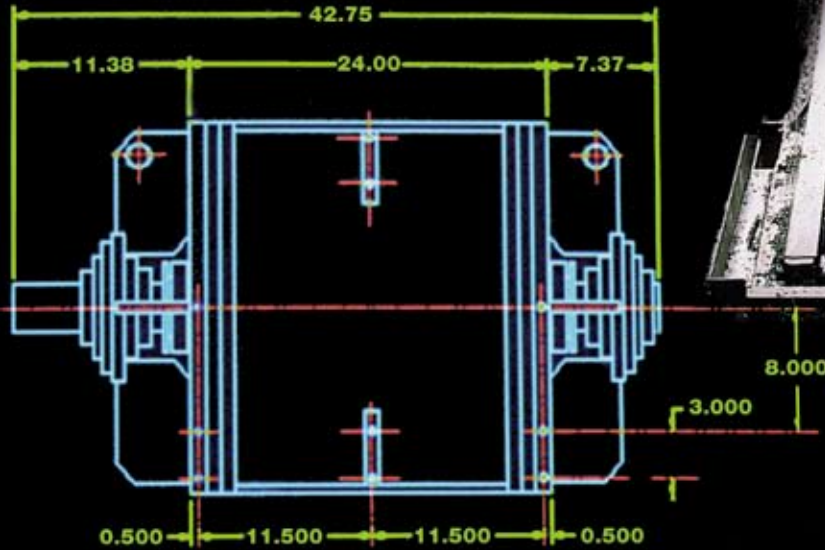

The PMV[®] Severe Duty Valve

The Precision Machine Valve, or PMV, is a breakthrough in rotary valve design. The revolutionary difference begins with its modular concept and continues to its absolute top quality fabrication and materials. Designed to maximize performance and productivity, the PMV excels in all critical areas. It is durable, dependable, adaptable – and it can be rebuilt on-site by your millwright.

Rebuild It Easily and Eliminate Downtime Delays

The PMV is a completely bolt-together unit, unlike other one-piece rotary valves. Individual components make ease of service and repair unparalleled.

Rebuilding the PMV is as simple as removing the correct bolts and replacing the worn piece with an identical new one. This includes the rotor, wear plates and even the barrel sides. The barrel sides can even be rotated to maximize functional life. To further simplify service, the precision fabricated pieces are dowel pinned for ease of alignment while the bolts are being secured.

An available knife gate assembly isolates the PMV and permits service while the valve is still in position.

Designed for Durability and Built to Last

The PMV thrives in the harshest industrial environments. A 500 Brinell alloy is used for the barrel

sides and rotor. This super-duty, work-hardening alloy is precision machined to three-decimal place tolerances. The barrel sides and end wear plates are then coated with RW-90 for superior extended wear protection. RW-90, exclusively formulated for Precision Machine, is chrome-like in appearance and hardness, but has superior wear characteristics when compared to chrome. High-temperature paint is used for added protection. Piloted flanged roller bearings ensure longer life and radial thrust loading.

Adapts to Your Existing System

Inlet and discharge transitions can be built to allow a PMV to fit any system. The sides of the unit are drilled to allow 3 or 9 o'clock drive mounting positions. Drives complete with motor, gearbox, sprockets, chain and OSHA-approved chain guard are also available.

The PMV Valve is precision-machined to three decimal place tolerances.

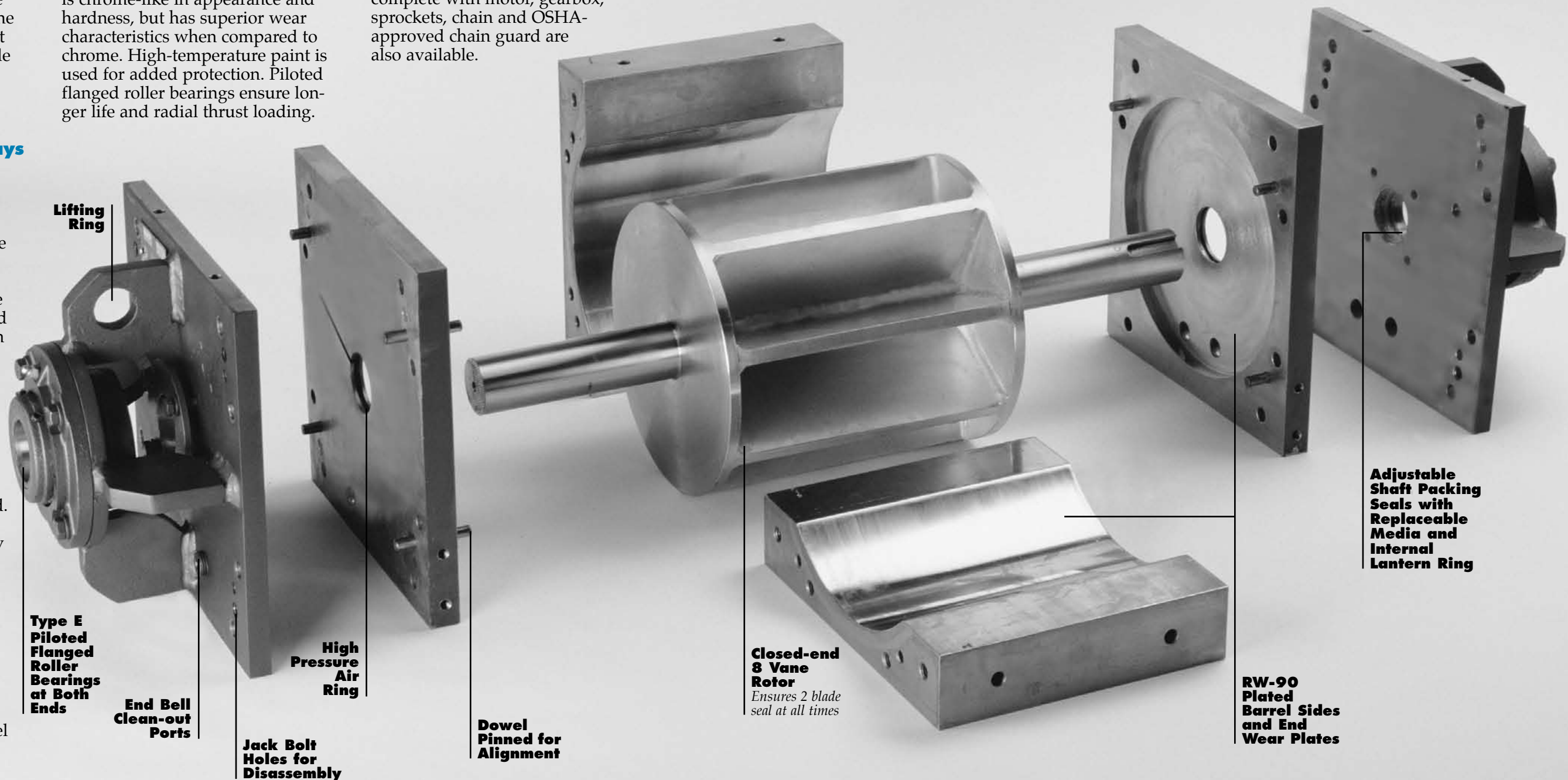

Lifting Ring

Type E
Piloted
Flanged
Roller
Bearings
at Both
Ends

End Bell
Clean-out
Ports

High
Pressure
Air
Ring

Jack Bolt
Holes for
Disassembly

Dowel
Pinned for
Alignment

Closed-end
8 Vane
Rotor
Ensures 2 blade
seal at all times

RW-90
Plated
Barrel Sides
and End
Wear Plates

Adjustable
Shaft Packing
Seals with
Replaceable
Media and
Internal
Lantern Ring



PMV[®] Valve

The PMV is a full-featured rotary valve. It is built for extreme durability, using the finest quality alloys throughout. Exclusive RW-90 plating is used in key places to prolong life.

Bolt-together design and precision-machined interchangeable components make the PMV extremely easy to rebuild and service. This modular design is enhanced by dowel-pinned parts that make alignment simple.

Any model PMV can be adapted to existing systems with inlet and discharge transitions.

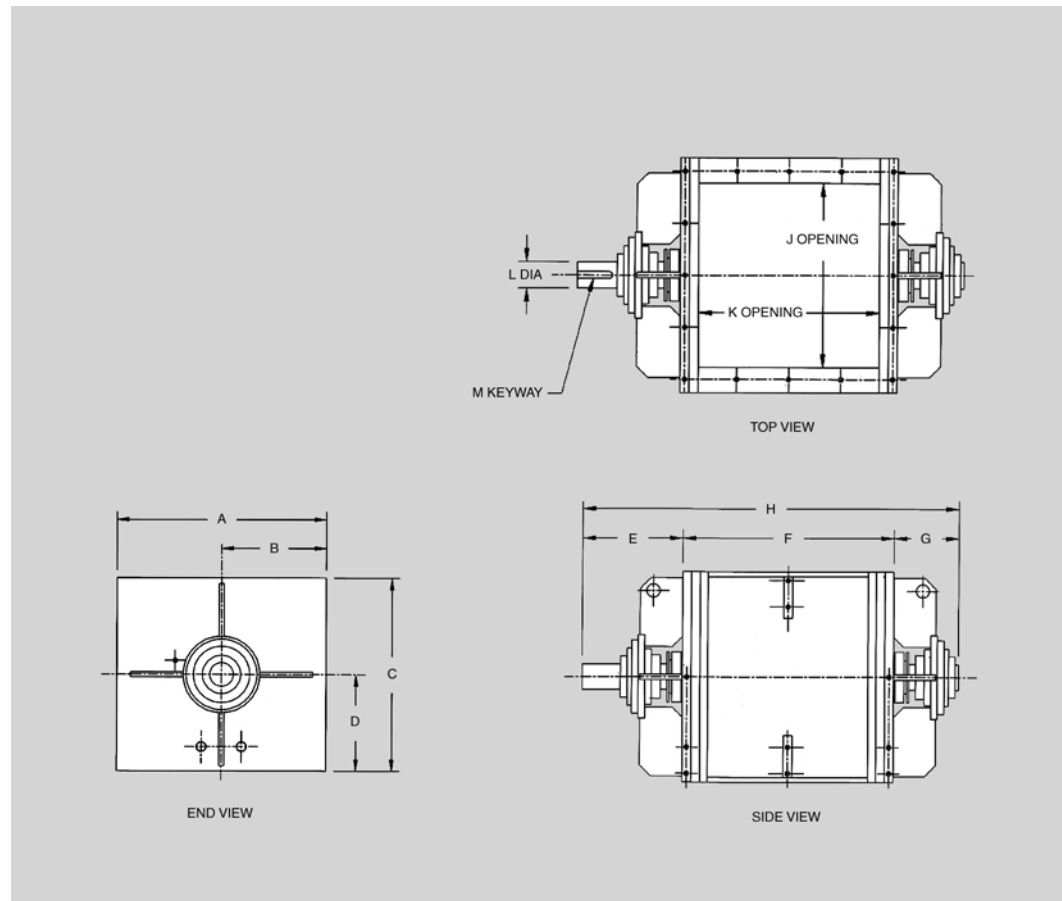

Note: Mounting dimensions available upon request from our engineering department.

DIMENSIONS

SIZE	A	B	C	D	E	F	G	H	J	K	L	M
PMV-8	11.00	5.50	10.00	5.00	8.68	11.40	5.67	25.75	6.50	8.00	1 15/16	1/2 x 1/4 x 2 3/4
PMV-10	12.00	6.00	12.00	6.00	8.68	13.40	5.67	27.75	7.00	10.00	1 15/16	1/2 x 1/4 x 2 3/4
PMV-12	15.00	7.50	15.00	7.50	8.68	15.40	5.67	29.75	9.00	12.00	1 15/16	1/2 x 1/4 x 2 3/4
PMV-14	18.00	9.00	17.00	8.50	10.31	18.00	7.19	35.50	9.62	14.00	2 7/16	5/8 x 5/16 x 2 3/4
PMV-16	21.75	10.88	20.00	10.00	10.31	20.00	7.19	37.50	10.75	16.00	2 7/16	5/8 x 5/16 x 2 3/4
PMV-18	24.00	12.00	22.00	11.00	11.38	22.00	7.37	40.75	18.00	18.00	2 15/16	3/4 x 3/8 x 3 1/2
PMV-20	26.00	13.00	24.00	12.00	11.38	24.00	7.37	42.75	20.38	20.00	2 15/16	3/4 x 3/8 x 3 1/2
PMV-22	30.00	15.00	26.00	13.00	13.00	26.25	8.00	47.25	22.00	22.00	3 7/16	7/8 x 7/16 x 4
PMV-24	32.00	18.00	29.00	14.50	14.19	28.25	8.69	51.13	24.00	24.00	3 7/16	7/8 x 7/16 x 4

PMV[®] Valve with Drive

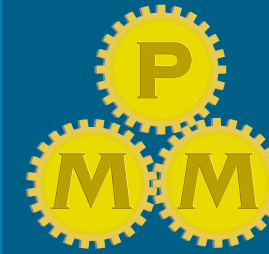

The standard reducer package is a shaft mount gear motor with an inverter duty motor.

Other drive options are available. Please contact us for information.

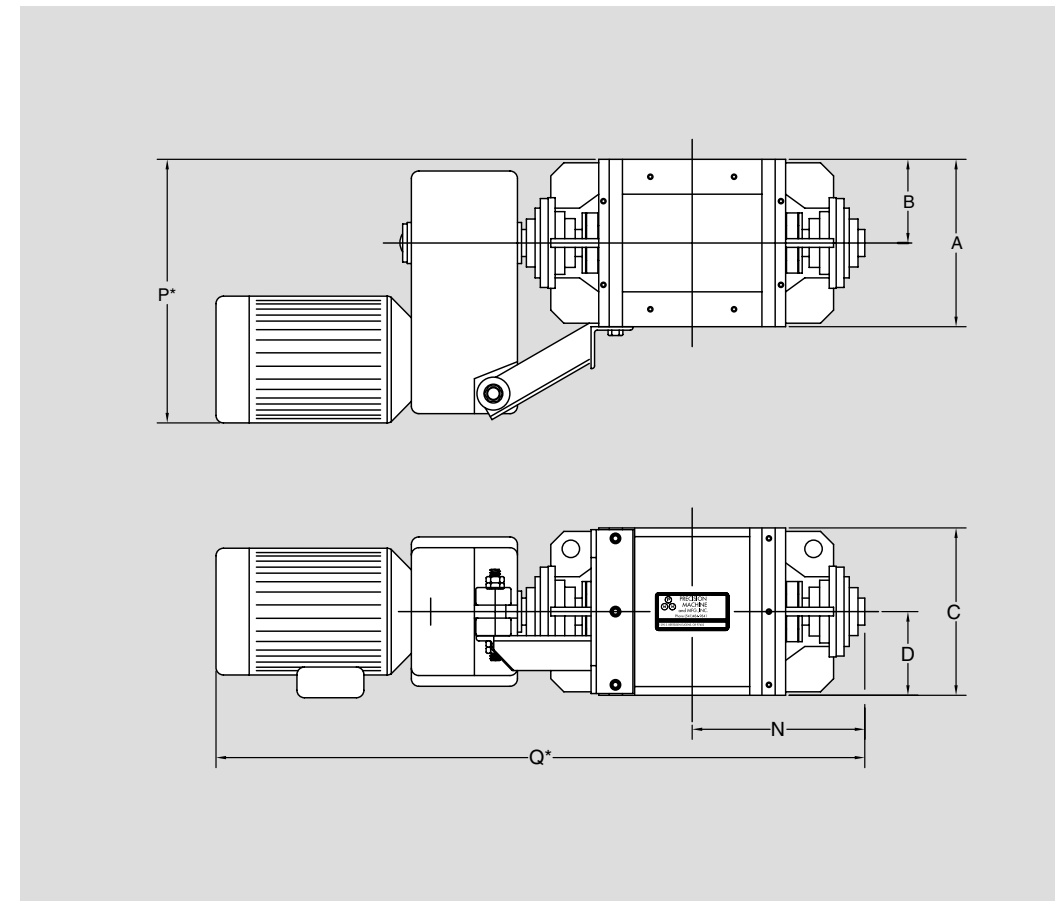

Note: Mounting dimensions available upon request from our engineering department.

DIMENSIONS

SIZE	HP	MAX. RPM	N	P	Q
PMV-8	1 1/2	48	11.37	16	40
PMV-10	2	48	12.37	19	46
PMV-12	2	32	13.37	21	49
PMV-14	2	30	16.19	22	55
PMV-16	2	25	17.19	24	57
PMV-18	3	25	18.37	27	57
PMV-20	5	22	19.37	29	63
PMV-22	7 1/2		21.13	35.00	72.63
PMV-24	10		22.81	36.06	76.75

*Reference only.



Capacities and Replacement Parts

All parts in the PMV® are interchangeable within the same size unit. So whether you have two or twenty PMVs, you only need to inventory a minimum of spare parts, eliminating expensive backup valves.

Any part you order will be shipped directly from our on-the-shelf inventory by the fastest method available.

CAPACITY (CU.FT./HR.)									
Size	PMV-8	PMV-10	PMV-12	PMV-14	PMV-16	PMV-18	PMV-20	PMV-22	PMV-24
CFR	0.17	0.34	0.62	1.00	1.60	2.25	3.10	4.00	5.14
RPM									
4	40.8	81.6	148.8	240.0	384.0	540.0	744.0	960.0	1233.6
6	61.2	122.4	223.2	360.0	576.0	810.0	1116.0	1440.0	1850.4
8	81.6	163.2	297.6	480.0	768.0	1080.0	1488.0	1920.0	2467.2
10	102.0	204.0	372.0	600.0	960.0	1350.0	1860.0	2400.0	3084.0
12	122.4	244.8	446.4	720.0	1152.0	1620.0	2232.0		
14	142.8	285.6	520.8	840.0	1344.0	1890.0	2604.0		
16	163.2	326.4	595.2	960.0	1536.0	2160.0	2976.0		
18	183.6	367.4	669.6	1080.0	1728.0	2430.0	3348.0		
20	204.0	408.0	744.0	1200.0	1920.0	2700.0	3720.0		
22	224.4	448.8	818.4	1320.0	2112.0	2970.0	4092.0		
25	255.0	510.0	930.0	1500.0	2400.0	3375.0	-----		
30	306.0	612.0	1116.0	1800.0	-----	-----	-----		
32	326.4	652.8	1190.4	-----	-----	-----	-----		
36	367.2	734.4	-----	-----	-----	-----	-----		
40	408.0	816.0	-----	-----	-----	-----	-----		
44	448.8	897.6	-----	-----	-----	-----	-----		
48	489.6	979.2	-----	-----	-----	-----	-----		

Severe Applications



The PMV is a millwright's dream. It can be completely rebuilt on-site in under two hours. Forget about down-time delays. The new, larger size makes many operations more efficient.

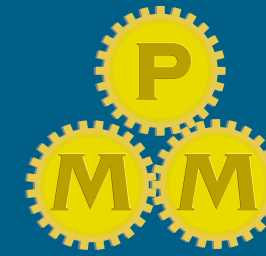

Applications and Capabilities

PMV® Severe-Duty and UltraValve Applications

Fly Ash and Bottom Ash
Lime
Sand
Cement
Fossilized Coral
Hot Sludge
Diatomaceous Earth
Recycled Glass
Petroleum Coke
Alumina Ore

PMV Standard-Duty Applications

Paper
Sawdust
Borax
Salt Cake
Agricultural Products
Chalk
Gypsum
Lactose
Soap
Sulphur

The design, quality and construction of the Severe-Duty PMV rotary valve make it ideally suited for the most demanding applications. It has proven capable of withstanding the harshest conditions and brutal production environments inherent to fields such as mining, electrical co-generation, concrete and recycling.

The PMV rotary valve is also available in a Standard-Duty model that offers the same performance of the severe-duty unit in a model designed for less demanding applications. It is commonly used in agriculture, mining and paper and wood products industries.

The UltraValve PMV is designed for those applications where coatings, such as hard chrome, are not desirable or when extreme wear has been a problem for other rotary valves. Contact us for more information.

Each PMV rotary valve features an eight-vane rotor design that gives a two-blade seal at all times. To further protect integrity, adjustable shaft packing glands with replaceable media prevent product and air leakage. Also, an air seal ring prevents contaminants from entering the packing media itself. The end bells feature clean-out ports and purge and seal air ports.

Regardless of the model, the PMV rotary valve can be counted on to provide reliable and effective conveyance of a vast array of materials and in a wide range of environments. It has proven itself time and again.

Numerous case histories and testimonials from satisfied customers are available upon request.

Over 2,000 PMV valves are in service throughout the world.



"I operated PMV valves for five years in extremely difficult service, bio-mass fuel delivery. The valves are very well engineered, dependable and rugged."

Bob Finch
Power Co-generation
Plant Maintenance
Manager



Precision Machine and Manufacturing, Inc.

- Screw Conveyor and Sectional Flights
- Chip Feeders
- Custom Machined Parts
- Welding and Fabrication



Precision Machine and Manufacturing, Inc. is an innovative and quality-oriented manufacturer of a diverse range of industrial products.

Combining machine shop operations, fabrication capabilities and a state-of-the-art CNC department, Precision Machine and Manufacturing, Inc. serves many customers in many different industries.

For 30 years we have made commitment to quality, service and cost efficiency for our customers a top priority. We have grown to become an industry leader capable of producing any machine component and able to handle any job.

From the agricultural to wood products industries, our manufactured products are known for quality, design and excellent workmanship. Throughout these industries you will find satisfied customers currently using our Screw Conveyors, Sectional Flights, Precision Chip Feeders and machining and fabrication services.

Now, with the revolutionary PMV[®], Precision Machine and Manufacturing, Inc. has taken the lead in rotary valve design. Call, fax or e-mail today for more information.



Precision Machine and Manufacturing, Inc.

1290 S. Bertelsen Rd.
Eugene, OR 97402-5700

Toll Free (800) 722-9841
Phone (541) 484-9841
Fax (541) 484-4094

E-mail: sales@premach.com
engineering@premach.com
Web Site: www.premach.com